

HOTĂRÂREA

privind aprobarea documentației cadastrale de primă înscriere în cartea funciară în favoarea Comunei Florești și introducerea în domeniul public al Comunei Florești a imobilului-teren în suprafață măsurată de 1348mp situat pe str. Andrei Mureșanu, loc. Florești, jud. Cluj

CONSILIUL LOCAL FLOREȘTI, întrunit în ședință ordinară în data de 28 martie 2024,

Luând în discuție Proiectul de hotărâre privind aprobarea documentației cadastrale de primă înscriere în cartea funciară în favoarea Comunei Florești și introducerea în domeniul public al Comunei Florești a imobilului-teren în suprafață măsurată de 1348mp situat pe str. Andrei Mureșanu, loc. Florești, jud. Cluj,

Analizând Referatul nr. 32087/25.03.2024, întocmit de primarul comunei Florești în calitate de inițiator, Raportul de specialitate nr. 32361 / 26.03.2024, precum și avizul comisiei de specialitate,

În conformitate cu prevederile Regulamentului de recepție și înscriere în evidențele de cadastru și carte funciară, aprobat prin Ordinul directorului general al Agenției Naționale de Cadastru și Publicitate Imobiliară nr. 600/2023, cu modificările și completările ulterioare,

În temeiul art. 129 alin. (2) lit. c) și art. 196 din OUG nr. 57/2019 privind codul administrativ,

HOTĂRĂȘTE :

Art. 1. Se declara de uz și utilitate publică imobilul-teren în suprafață măsurată de 1348mp situat pe str. Andrei Mureșanu, loc. Florești, jud. Cluj și se introduce în domeniul public.

Art. 2. Se aprobă documentația cadastrale de primă înscriere în cartea funciară în favoarea Comunei Florești și introducerea în domeniul public al Comunei Florești a imobilului-teren în suprafață măsurată de 1348mp situat pe str. Andrei Mureșanu, loc. Florești, jud. Cluj, identificate conform anexei nr. 1 prezentei.

Art. 3. Prezenta hotărâre se comunică, prin intermediul secretarului general al comunei Florești, în termen de maximum 10 zile lucrătoare de la adoptare, Primarului Comunei Florești, Prefectului Județului Cluj și se aduce la cunoștință publică, în termen de 5 zile de la data comunicării oficiale către prefect, prin afișare la sediul Primăriei, respectiv pe pagina de internet aferentă www.floreșticluj.ro.

Nr. 50 din 28 martie 2024

TOTAL CONSILIERI 19

Prezenți 19

Voturi pentru 19



Președinte de ședință,
Danciu Emil

Contrasemnează secretar general,
Orza Alin Răzvan



**Documentație cadastrală pentru înscrierea în cartea
funciară a imobilului situat în comuna Florești, str. Andrei
Mureșanu, jud. Cluj.**

Beneficiar: COMUNA FLOREȘTI

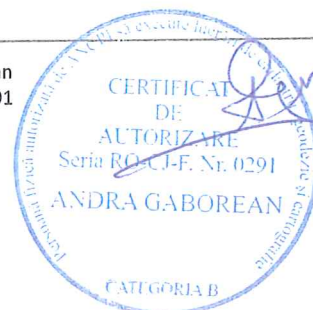

PLAN DE AMPLASAMENT SI DELIMITARE A IMOBILULUI

intravilan
Scara 1:500

Nr. cadastral	Suprafata masurata	Adresa imobilului
	1348mp	Loc. Floresti, Str. Andrei Muresanu, jud. Cluj
Cartea Funciara nr.		UAT Floresti

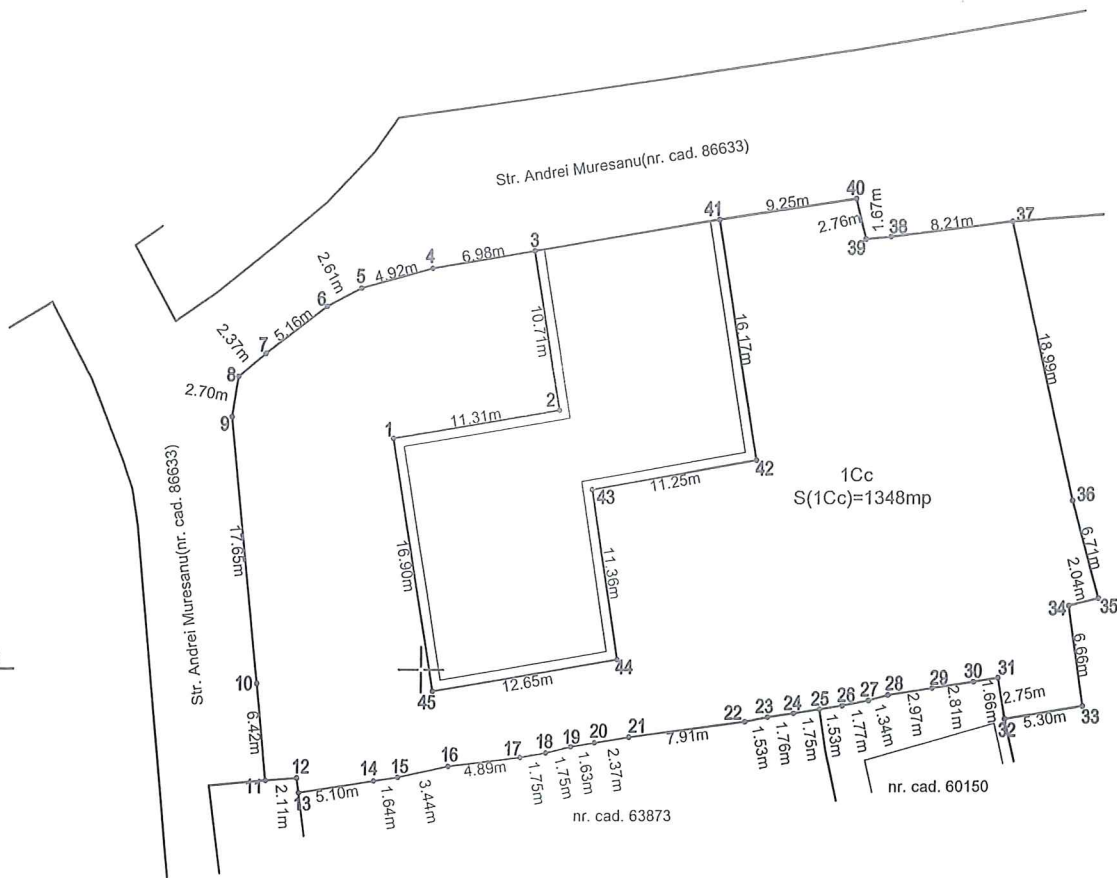

A. Date referitoare la teren

Nr. parcela	Categoria de folosinta	Suprafata [mp]	Mentuni
1Cc	Curti constructii	1348	Teren imprejuiat in partea de Est si Vest si partial imprejuiat in partea de Nord si Sud.
Total		1348	---

B. Date referitoare la constructii

Cod constr.	Destinatia	Suprafata construita la sol [mp]	Mentuni
---	---	---	---
Total		---	---

Suprafata totala masurata a imobilului = 1348mp
Suprafata din act = 1348mp

Intocmit | Ing. Andra Gaborean
Aut. Seria | RO-CJ-F | Nr. 0291



Inspector,

Confirm introducerea imobilului in baza de date integrata si atribuirea numarului cadastral

Confirm executarea masuratorilor la teren, corectitudinea intocmirii documentatiei cadastrale si corespondenta acestora cu realitatea din teren.

Data: Martie 2024

Data:

PLAN DE INCADRARE IN ZONA

scara 1:2000

Adresa imobil: com. Floresti, str. Andrei Muresanu, jud. Cluj



 Zona amplasament



MEMORIU TEHNIC

1. **Adresa imobilului:** Imobilul este situat in intravilanul com. Floresti, str. Andrei Muresanu, jud. Cluj;
2. **Tipul lucrarii:** Documentatie cadastrala de prima inscriere;
3. **Suprafata planului supus receptiei:** 1348mp;
4. **Scurta prezentare a scopului intocmirii lucrarii si/sau a situatiei tehnice si juridice/istoricului**

Documentatia a fost intocmita la cererea beneficiarului, in vederea primei inscrieri imobilului, respectiv atribuirea numarului cadastral si crearea unei carti funciare pentru amplasamentul prezentat in planul de amplasament si delimitare a imobilului.

Imobilul este situat in intravilanul com. Floresti, str. Andrei Muresanu, jud. Cluj, are categoria de folosinta "curti-constructii" si suprafata 1348mp. Imobilul se va inscrie in favoarea comunei Floresti – domeniu public.

5. Descrierea generala a operatiunilor efectuate

a.) Faza de documentare pentru efectuarea lucrarii:

- s-au studiat actele necesare pentru realizarea documentatiei, puse la dispozitie de catre beneficiar;
- s-au coroborat actele cu informatiile actualizate din baza de date electronica a OCPI Cluj;
- s-a stabilit data efectuarii masuratorilor.

b.) Localizarea si identificarea imobilului:

- limitele au fost indicate de catre proprietar si s-au efectuat masuratorile necesare;
- amplasamentul este localizat in intravilanul com. Floresti, str. Andrei Muresanu, jud. Cluj si este imprejmuit in partea de est si vest si partial imprejmuit in partea de nord si sud;
- amplasamentul se identifica pe nomenclatura: **L-34-47-D-d-2-II**

6. Operatiuni de specialitate realizate

Pentru efectuarea masuratorilor s-a utilizat metoda drumuirii sprijinite combinata cu radierea. Legatura in sistem national de referinta Stereografic 1970 si Sistem de cote Marea Neagra 1975 s-a realizat cu aparatura GPS, folosind metoda de lucru RTK. Transformarile de coordonate s-au executat



cu ajutorul programului TransDatRo 4.1, implementat in carnetul de teren al GPS-ului. S-a stationat pe **cui determinat GPS-1** cu vize pe **cui determinat GPS-2**. Aparatul folosit la masuratori a fost statia totala Nikon NPR 362, iar datele au fost prelucrate cu ajutorul programului Terramodel.

Prin metoda RTK-cinematic in timp real, s-au utilizat in timp real corectii diferentiate provenite de la statia de referinta integrata in RGN – GNSS Cluj prin serviciul specializat ROMPOS.

Acuratetea de pozitionare este, in mod RTK, pe orizontala = $1\text{ cm} \pm 1\text{ ppm (RMS)}$ si pe verticala = $2\text{ cm} \pm 1\text{ ppm (RMS)}$, iar in mod static, pe orizontala = $3\text{ mm} \pm 1\text{ ppm (RMS)}$ si pe verticala = $5\text{ mm} \pm 1\text{ ppm (RMS)}$.

Folosind metoda de lucru RTK, coordonatele punctelor masurate au fost calculate in timp real in Sistemul de Coordonate Stereografic 1970 si Sistemul de Cote Marea Neagra 1975. Datele stocate in memoria aparatului au fost ulterior descarcate si stocate pe un calculator. Prin intermediul software-ului Surv CE s-au colectat si prelucrat datele prin aplicarea de corectii diferentiate provenite de la statia de referinta prin intermediul cartelei GSM introduse in receptor. Astfel, transcalculul coordonatelor determinate cinematic din sistem geocentric in sistem national de referinta s-a realizat utilizand software-ul TransDat RO.

Calculul suprafetelor: s-a efectuat prin metoda analitica, coordonatele punctelor de contur ale parcelei sunt prezentate în tabelul de mai jos:

Suprafata teren

No. Pnt.	X [m]	Y [m]
1	583965.255	384597.990
2	583967.115	384609.150
3	583977.677	384607.350
4	583976.513	384600.465
5	583975.196	384595.720
6	583973.967	384593.421
7	583970.816	384589.339
8	583969.285	384587.526
9	583966.614	384587.120
10	583949.057	384588.966
11	583942.672	384589.609
12	583942.833	384591.711
13	583941.865	384591.847
14	583942.659	384596.880
15	583942.904	384598.503
16	583943.642	384601.868
17	583944.237	384606.721
18	583944.523	384608.447
19	583944.931	384610.151
20	583945.196	384611.756



21	583945.569	384614.093
22	583946.574	384621.943
23	583946.867	384623.449
24	583947.124	384625.191
25	583947.388	384626.921
26	583947.619	384628.438
27	583947.957	384630.172
28	583948.314	384631.461
29	583948.756	384634.396
30	583949.173	384637.172
31	583949.430	384638.808
32	583946.725	384639.293
33	583947.555	384644.532
34	583954.145	384643.550
35	583954.623	384645.531
36	583961.093	384643.747
37	583979.599	384639.504
38	583978.582	384631.360
39	583978.424	384629.697
40	583981.107	384629.029
41	583979.751	384619.878
42	583963.802	384622.542
43	583961.894	384611.450
44	583950.679	384613.243
45	583948.584	384600.769
Suprafata total masurata = 1348mp		

INVENTAR DE COORDONATE

- 1 583980.4150 384583.8610 369.3960
- 1 584022.6240 384600.7540 372.6811 CCL
- 3 584023.7289 384606.8203 373.7758 PCL
- 4 584024.6033 384611.7234 373.9617 CCL
- 5 584016.6180 384612.9785 372.3712 CCL
- 6 584016.5870 384612.9881 379.8413 CCL
- 7 583999.2356 384604.3846 371.5953 PCL
- 8 583991.3336 384605.6900 372.0845 PCL
- 9 583988.1535 384606.2162 371.7550 CCL
- 10 583989.0977 384612.7355 370.8876 PCL
- 11 583989.7931 384617.4737 370.6724 CCL
- 12 583979.7156 384619.2346 370.4003 CCL
- 13 583978.5525 384612.4635 370.9037 PCL
- 14 583977.7974 384607.9789 370.9101 CCR
- 15 583971.3774 384609.0369 371.5587 PCL
- 16 583966.6244 384609.8608 372.4569 XCL
- 17 583966.0709 384606.6309 372.0436 PCL
- 18 583965.0778 384600.7852 371.5933 PCL
- 19 583964.7289 384598.7265 371.5232 CCL
- 20 583958.6470 384599.7404 371.6682 PCL

E-mail: andra@topoland.ro
 Mobil: 0741 784 393

Intocmit | Ing. Andra Gaborean
 Aut. Seria | RO-CJ-F | Nr. 0291



21 583952.4879 384600.7427 371.3288 PCL
22 583935.6591 384584.7726 369.4280 ST
23 583948.4154 384588.9676 371.1235 CGAR
24 583948.5668 384592.1734 371.1851 PGAR
25 583943.2820 384600.9510 371.6035 PGAR
26 583983.5160 384637.0372 368.9601 ST
27 584004.1286 384600.7461 369.1853 ST
22 583935.6591 384584.7726 369.4280
28 583942.7844 384589.5181 370.8127 CGAR
29 583942.7209 384589.6683 370.8119 G
30 583942.9606 384591.6964 371.4566 GARAJXGBET
31 583939.2227 384592.2486 371.4620 CGBET
32 583940.7807 384602.2022 371.2298 G
33 583942.8197 384614.6374 371.3321 G
34 583943.9562 384621.8092 371.2349 3XGBET
35 583940.2762 384622.6337 371.0143 G
36 583935.6542 384598.7086 371.2509 CCL
37 583934.0192 384590.5715 371.5735 CCL
38 583945.5785 384589.2453 370.5104 PGAR
39 583949.3061 384601.2758 374.2187 CCL
40 583950.1672 384606.3431 375.7342 PCL
41 583951.2054 384612.5113 376.4345 CCL
42 583944.0391 384629.9311 372.7274 CCL
43 583940.5437 384630.7032 372.1156 PCL
44 584017.8166 384573.0179 374.3140 CCL
45 584022.5431 384583.6326 371.6447 CCL
27 584004.1286 384600.7461 369.1853
46 584003.5422 384603.6807 370.9224 CCL
47 584003.9717 384606.5080 370.8233 PCL
48 584004.8323 384612.3621 370.8562 PCL
49 584006.0186 384614.7614 370.8703 PCL
50 584011.7223 384613.7992 370.8765 PCL
51 584005.2064 384614.8927 370.6353 XCL
52 584008.4018 384612.8069 369.1949 MTR
53 584009.5916 384612.4909 369.1856 MTR
54 584016.6382 384612.9670 370.9296 CCL
55 584021.8524 384616.7436 370.4526 XGAR
56 584025.2800 384616.1363 370.6251 CGAR
57 584024.8779 384612.1124 372.9006 CCR
58 584024.6268 384611.7110 377.4831 CCR
59 584037.8773 384621.1064 374.3677 CCR
26 583983.5160 384637.0372 368.9601
60 583997.1306 384616.3182 371.9147 PCL
61 584001.2483 384615.6494 371.6667 XCL
62 584001.7371 384619.0435 371.0651 PCL
63 584002.4231 384623.7773 371.5266 PCL
64 584002.8607 384626.8613 371.3624 CCL
65 584005.2213 384626.4675 370.7137 PCL

E-mail: andra@topolando.ro
Mobil: 0741 784 393

Intocmit | Ing. Andra Gaborean
Aut. Seria | RO-CJ-F | Nr. 0291



66 584013.8468 384625.0227 370.6189 PCL
67 583992.3594 384635.8962 369.2599 CGAR
68 583992.9384 384639.2549 369.8389 XGAR
69 583993.5196 384642.6511 370.8682 XGAR
70 583993.8742 384645.3245 371.1256 GMETXCGAR
71 583994.3281 384645.5539 372.5013 CCL
72 583994.8437 384651.2187 372.4954 CCL
73 583994.5996 384648.5071 372.0086 PCL
74 584029.6697 384640.3121 374.6952 CCL
75 584030.5594 384645.3087 376.0789 PCL
76 584031.5929 384651.5916 377.3401 CCR
77 584044.3507 384658.1999 380.0344 PCL
78 583997.4108 384634.9473 370.2350 XGAR
79 584001.0767 384634.1569 370.1430 XGAR
80 584003.9825 384633.6740 370.1532 XGAR
81 584007.1797 384633.1328 370.0865 CGAR
82 584010.0705 384632.6462 370.0264 CGAR
83 583991.9821 384645.7725 370.6448 CG
84 583953.6423 384627.5281 368.9278 ST
85 583979.6226 384639.4989 370.4872 XG
86 583976.5829 384640.1629 370.4280 GMETXGPL
87 583976.8062 384640.6017 371.1690 CCL
88 583971.5599 384641.8647 371.4443 PCL
89 583960.7235 384644.0617 371.4786 CG
90 583961.0931 384643.7466 368.8669 CAPGPL
91 583961.0327 384643.7049 370.7999 CGAR
92 583951.6574 384636.4984 371.5714 XGAR
93 583951.2829 384633.8528 370.7749 XGAR
94 583950.8322 384631.3017 370.1175 CGAR
95 583947.9768 384630.5154 370.5924 PGAR
96 583964.3253 384621.8060 377.3594 CCL
97 583951.2304 384612.5113 371.5686 CCL
98 583946.4676 384638.7265 372.7608 CCL
99 583945.2345 384634.2305 372.9096 PCL
84 583953.6423 384627.5281 368.9278
100 583960.2805 384638.8270 370.5247 CGAR
101 583960.0534 384638.6968 370.5259 PGAR
102 583957.1056 384638.7799 370.5276 XGAR
103 583953.1619 384639.4665 370.5276 XGAR
104 583960.7266 384644.4743 373.0628 CCL
105 583950.1193 384644.1496 371.4915 PGAR
106 583949.5212 384631.4866 370.3389 PGAR
107 583948.1568 384631.7053 370.9193 XGAR
108 583945.3504 384630.2460 371.1716 PGAR
109 583947.7016 384628.3561 370.7688 PGAR
110 583946.8951 384623.4816 370.8355 PGAR
111 583946.5661 384621.8565 370.7705 XGAR
112 583948.5895 384621.5473 370.6332 CGAR

E-mail: andra@topoland.ro
Mobil: 0741 784 353

Intocmit | Ing. Andra Gaborean
Aut. Seria | RO-CJ-F | Nr. 0291



113 583948.1952 384619.0709 370.6566 XGAR
114 583948.3214 384618.9846 370.6566 CGAR
115 583947.7795 384616.4569 370.4398 CGAR
116 583947.1598 384613.9857 370.4186 CGAR
117 583943.8240 384604.4692 370.5557
118 583943.8241 384604.4697 370.5557 PGAR
119 583942.8022 384598.1343 370.5549 PGAR
120 583942.4138 384595.6595 371.0459 XGAR
121 583943.3254 384595.5572 370.7187 XGAR
122 583945.9174 384595.3710 370.7156 XGAR
123 583954.7899 384611.9417 371.6467 PCL
124 583951.2287 384612.5108 371.5384 CCL
125 583949.3206 384601.2951 370.6304 CCL
126 583960.1829 384611.0801 372.3195 PCL
127 583962.4172 384610.7182 372.4446 XCL
128 583963.0220 384614.1738 372.1801 PCL
129 583964.0311 384620.0930 371.8264 PCL
130 583964.0311 384620.0929 371.8265 PCL
131 583960.3717 384613.2452 369.1093 MTR
132 583969.0017 384641.9062 369.2622 GPL
133 583965.9689 384643.2313 371.7151 PCL
2 584037.7650 384624.7650 369.0190
134 584018.2437 384624.2730 371.0427 CCL
135 584012.7814 384625.1860 370.9108 PCL
136 584026.1543 384621.9456 371.5422 CGAR
137 584019.3025 384622.9228 370.8088 CGAR
138 584022.6414 384622.5305 370.7779 XGAR
139 584025.6618 384611.5665 370.7798 PCL
140 584033.9791 384610.2583 370.7567 PCL
141 584035.8978 384609.9149 375.7121 XCL
142 584036.5850 384614.1791 372.5329 PCL
143 584037.8496 384621.1317 370.9924 CCL
144 584013.1249 384632.1263 370.3207 CGAR
145 584013.7198 384635.5650 370.3697 PGAR
146 584014.8860 384636.6306 370.4355 CGAR
147 584018.4192 384635.9371 370.4325 XGAR
148 584021.2408 384635.4866 370.1939 XGAR
149 584024.3782 384634.9843 370.2581 XGAR
150 583747.4963 384901.3805 361.6585 CGAR
151 584027.5758 384634.4749 370.3206 CGAR
152 584028.2722 384638.6249 370.2593 PGAR
153 584029.6637 384640.2628 371.8194 CCL
154 584045.0415 384637.6115 371.4626 CCL
155 584028.3285 384638.9305 370.6068 PGA158CMCGAR
156 584053.1060 384618.6718 370.4301 CCL
157 584046.8012 384619.6654 370.5068 PCL
pt0,583972.3040,384582.1066,369.5779,capzxd
pt1,583972.7308,384582.0064,369.4064,cappocxz

E-mail: andra@topoland.ro
Mobil: 0741 784 393

Intocmit | Ing. Andra Gaborean
Aut. Seria | RO-CJ-F | Nr. 0291



pt2,583976.8178,384579.5771,369.4815,cappocxz
pt3,583974.0767,384575.2297,369.4243,cappocxz
pt4,583969.9680,384577.7405,369.4923,cappocxz
pt5,583963.6933,384581.1371,369.2371,md
pt6,583969.1709,384577.6438,369.3387,capgpl
pt7,583961.8005,384580.5143,369.0928,frgpl
pt8,583959.3245,384580.9386,369.1004,frgpl
pt9,583960.4833,384581.9790,369.2024,md
pt10,583961.3156,384584.4689,369.1761,md
pt11,583965.2156,384584.3333,369.1486,md
pt12,583967.6863,384585.0217,369.1616,md
pt13,583970.0622,384587.0990,369.1753,md
pt14,583972.6301,384590.1380,369.1839,md
pt15,583974.9888,384593.3972,369.1613,md
pt16,583975.8376,384595.2572,369.1601,md
pt17,583977.6873,384601.1654,369.0692,md
pt18,583979.1679,384607.3625,369.0038,md
pt19,583977.4205,384606.1558,369.1540,gpl
pt20,583976.4763,384600.4141,369.1794,gpl
pt21,583975.1895,384595.7385,369.2582,gpl
pt22,583973.9255,384593.3707,369.3063,gpl
pt23,583969.3197,384587.5161,369.2617,frgpl
pt24,583966.5629,384587.0507,369.1510,frgpl
pt25,583963.7837,384587.2083,369.1753,gpl
pt26,583957.2156,384584.9883,369.1519,md
pt27,583956.7752,384585.3527,369.1611,mdxtr
pt28,583954.2708,384585.4313,369.1091,mdxtr
pt29,583957.0648,384587.9416,369.0924,gplmtr
pt30,583955.1773,384588.2233,369.0491,gplmtr
pt31,583949.1127,384588.9691,369.1963,gplxgbet
pt32,583948.7742,384585.6642,369.1602,md
pt33,583948.3541,384583.1224,369.1134,md
pt34,583948.4230,384581.9349,369.0263,gpl
pt35,583937.9668,384582.9048,369.2357,gpl
pt36,583938.2191,384584.0042,369.3275,md
pt37,583938.4808,384586.6190,369.3027,md
pt38,583938.8431,384590.0574,369.5046,gmet
pt39,583942.8304,384589.6731,369.3640,gmetxgar
pt40,583934.6896,384590.5010,369.4803,gmetxgbet
pt41,583982.2653,384571.0010,369.1259,mdmtr
pt42,583983.8973,384570.4560,369.2345,glmn
pt43,583980.1498,384578.7175,369.1502,xd
pt44,583975.3561,384570.2901,369.0996,xd
pt45,583975.1657,384585.7062,369.3930,mz
pt46,583974.8024,384585.9274,369.2626,mz
pt47,583977.8262,384589.8966,369.2092,mz
pt48,583978.2427,384589.5937,369.3979,mz
pt49,583981.5833,384593.3311,369.4908,mz

E-mail: andra@topoland.ro
Mobil: 0741 784 393

Intocmit / Ing. Andra Gaborean
Aut. Seria | RO-CJ-F | Nr. 0291



pt50,583981.2608,384593.6612,369.4682,mz
pt51,583983.6627,384596.0517,369.2087,mzfrd
pt52,583983.9699,384595.6609,369.4265,mz
pt53,583987.1353,384597.8526,369.3990,mz
pt54,583986.8756,384598.3159,369.4601,mz
pt55,583988.2898,384599.0419,369.4244,mz
pt56,583988.3580,384598.4802,369.4282,mz
pt57,583990.8218,384599.1256,369.5254,mz
pt58,583990.7732,384599.7728,369.3870,mz
pt59,583994.6232,384599.4563,369.3859,mz
pt60,583995.1002,384599.9514,369.3129,mz
pt61,584003.9525,384598.3548,369.2700,mz
pt62,584004.1035,384598.6772,369.2494,mz
pt63,584015.1751,384596.4601,369.2184,mzcappod
pt64,584017.1632,384596.0335,369.2351,mzcappod
pt65,584017.8864,384596.4164,369.1630,mz
pt66,584015.0840,384596.8082,369.2090,mz
pt67,584015.3397,384597.2299,369.2657,mtr
pt68,584015.2746,384597.9665,369.1555,mtr
pt69,584014.7935,384598.5816,369.1611,mtr
pt70,584017.3797,384596.9726,369.2093,mtr
pt71,584018.3684,384597.9446,369.1397,mtr
pt72,584018.8652,384599.8772,369.1711,mtr
pt73,584014.5479,384600.6156,369.1760,xtr
pt74,584012.9899,384601.0328,369.1736,frgplxtr
pt75,584014.2529,384601.9421,369.3124,gpl
pt76,584014.9253,384601.8565,369.2652,3xgpl
pt77,584003.1930,384602.5676,369.1662,3xgpl
pt78,584003.1423,384602.4493,369.1402,mtr
pt79,584002.7870,384600.5438,369.1817,mtr
pt80,583993.6982,384602.0532,369.1037,fitr
pt81,583994.8666,384603.8669,369.1269,fitr
pt82,583991.9196,384603.8772,369.0957,fitr
pt83,583989.1855,384601.4008,369.1395,fitr
pt84,583987.7084,384603.0057,369.1524,xtr
pt85,583986.4720,384602.6013,369.2390,xtr
pt86,583984.5452,384602.0108,369.1387,captrmd
pt87,583984.0602,384598.3691,369.1704,captrmd
pt88,583988.3000,384605.0016,369.1302,cgpl
pt89,583996.9815,384603.5931,369.1182,gpl
pt90,584010.9947,384606.6539,369.1630,tr
pt91,584011.8443,384607.0040,369.1279,tr
pt92,584015.8006,384607.8656,369.3915,gpl
pt93,584022.6533,384601.2099,368.8310,capgpl
pt94,584028.8378,384598.3172,369.2031,ctr
pt95,584031.3894,384593.5442,368.9623,mz
pt96,584031.5106,384593.9931,368.9467,mz
pt97,584031.9959,384595.7863,369.0648,tr

E-mail: andra@topoland.ro
Mobil: 0741 784 399

Intocmit | Ing. Andra Gaborean
Aut. Seria | RO-CJ-F | Nr. 0291



pt98,584032.5590,384597.6100,369.1969,tr
pt99,584038.0251,384596.9005,369.1611,cgpl-ccl
pt100,584037.9764,384596.9041,369.1964,cgpl-ccl
pt101,584037.7075,384596.7448,369.1597,mtr
pt102,584045.4115,384595.3743,369.1266,mtr
pt103,584045.3935,384595.8390,369.2132,gpl
pt104,584045.0446,384593.5015,369.0614,mtr
pt105,584044.7266,384591.4442,368.9447,mz
pt106,584055.1317,384589.6467,368.9924,mzcappod
pt107,584056.0991,384591.6006,369.0974,xtr
pt108,584056.6196,384594.1403,369.1062,xtr
pt109,584055.1485,384593.8240,369.1155,mtr
pt110,584055.8565,384594.0945,369.1163,cgpl
pt111,584056.0519,384595.2809,369.1374,cgpl
pt112,584056.7575,384598.2188,369.1058,cgpl
pt113,584056.1951,384598.3266,369.8070,cghena
pt114,584055.6455,384595.4446,369.7435,cghena
pt115,584052.9492,384595.8458,369.2150,cghena
pt116,584054.3325,384584.9099,369.5093,mzcappod
pt117,584058.2032,384606.2647,369.1129,gpl
pt118,584058.6786,384606.1825,369.0404,mtr
pt119,584060.2751,384615.2091,368.9829,mtr
pt120,584060.3858,384616.2964,368.9908,mtr
pt121,584060.0737,384617.2767,369.0004,mtr
pt122,584059.1906,384617.7793,369.0086,mtr
pt123,584059.5338,384617.1571,369.1806,cgpl
pt124,584059.0554,384619.3410,368.8819,mtr
pt125,584054.9038,384617.9924,369.1940,gpl
pt126,584054.3992,384618.4540,369.0591,mtr-ccl
pt127,584054.3195,384620.0519,368.8261,mtr
pt128,584054.7587,384624.5225,368.9007,dmparc
pt129,584055.6986,384628.3669,368.9207,dmparc
pt130,584056.7634,384632.7694,368.9134,mtr
pt131,584061.0102,384632.1806,368.8336,mtr
pt132,584050.7965,384635.4358,368.9783,gmetmtr
pt133,584046.6346,384635.8796,369.2384,frtmetmtr-ccl
pt134,584044.0817,384636.0287,369.3441,frtr
pt135,584046.0102,384634.3192,369.3636,frtr
pt136,584047.8070,384633.9381,369.3516,mtr
pt137,584027.9396,384622.6666,369.1926,cgpl
pt138,584027.8057,384621.6568,369.2319,cgpl
pt139,584026.6576,384622.9601,369.1837,ctr
pt140,584027.0688,384624.3895,369.0486,mtr
pt141,584027.4076,384628.8702,369.1708,dcparc
pt142,584029.1632,384634.4275,369.1102,captreparc
pt143,584029.8944,384638.6306,369.0932,ctr
pt144,584042.4227,384631.6817,369.7134,frdmparc
pt145,584047.1798,384629.7060,369.0271,frdmparc

E-mail: andra@topoland.ro
Mobil: 0741 784 393

Intocmit | Ing. Andra Gaborean
Aut. Seria | RO-CJ-F | Nr. 0291



pt146,584039.1078,384627.0294,369.0685,dmparc
pt147,584037.2168,384622.7833,369.0229,mtr
pt148,584036.2830,384621.4450,369.1669,mtr
pt149,584036.1439,384621.3206,369.1324,gpl
pt150,584035.0922,384621.6236,369.1673,xtr
pt151,584034.1286,384621.7639,369.1695,xtr
pt152,584034.0897,384614.9945,369.1250,mtr
pt153,584033.1610,384615.4655,369.1826,mtr
pt154,584018.6719,384625.6707,368.9766,mtr
pt155,584001.5738,384628.8041,369.4703,mtr
pt156,584000.3950,384627.3833,369.0540,xtrgpl
pt157,583999.3205,384627.5466,369.0657,xtrgpl
pt158,583998.3427,384620.2066,369.0902,mtr
pt159,583999.3219,384619.9984,369.0673,mtr
pt160,583991.3458,384628.9023,369.0482,cgpl
pt161,583991.2258,384628.9651,369.0736,ctr
pt162,583991.6027,384630.0067,368.9151,ctr
pt163,583989.9614,384629.7326,368.9436,dcaptr
pt164,583988.9156,384629.0550,368.9730,md
pt165,583988.2432,384627.9251,369.1658,mdcghena
pt166,583987.7747,384624.8947,369.2503,mdcghena
pt167,583987.7206,384624.1148,369.2274,mdcghena
pt168,583987.2964,384621.1191,369.2181,mdcghena
pt169,583988.8051,384620.9055,369.1889,cghena
pt170,583989.2217,384623.9036,369.2153,cghena
pt171,583989.3096,384624.6655,369.1790,cghena
pt172,583989.7238,384627.7052,369.1871,cghena
pt173,583989.4471,384624.1157,369.2701,mtr
pt174,583990.4678,384623.5288,369.3639,gpl
pt175,583990.6548,384623.4669,369.3085,gpl
pt176,583990.4729,384623.5429,369.3938,mtr
pt177,583986.8660,384605.1105,369.1913,mtr
pt178,583987.9823,384604.8810,369.2968,mtr
pt179,583981.1335,384620.9382,368.9956,md
pt180,583979.9210,384621.1322,369.0932,gpl-cl
pt181,583981.0929,384629.0232,369.1787,capgpl
pt182,583982.1177,384628.8625,369.1113,cghena
pt183,583982.4450,384631.0719,369.4770,cghena
pt184,583982.5127,384631.0715,368.9384,mdcaptr
pt185,583982.5168,384631.7417,368.9514,md
pt186,583981.8947,384632.6446,368.9675,md
pt187,583980.9780,384633.0747,368.9643,md
pt188,583982.6504,384637.3382,368.9252,md
pt189,583983.2332,384637.6772,368.9486,md
pt190,583983.4934,384638.3547,368.9399,md
pt191,583989.6144,384637.5450,368.9384,md
pt192,583989.9969,384636.5046,368.9331,md
pt193,583990.4485,384636.1735,368.9373,md

E-mail: andra@topoland.ro
Mobil: 0741 784 393

Intocmit | Ing. Andra Gaborean
Aut. Seria | RO-CJ-F | Nr. 0291



pt194,583991.9429,384635.7669,368.9304,md
pt195,583978.7888,384632.1010,369.4446,cghenactr
pt196,583978.6361,384631.3774,369.0072,capgplctr
pt197,583978.3909,384629.6037,369.1711,cghena
pt198,583972.4067,384632.5052,369.0377,xtr
pt199,583974.3297,384632.1316,369.0402,xtr
pt200,583970.6982,384622.3025,369.0451,xtr
pt201,583972.6759,384621.8491,369.0486,mtr
pt202,583970.3429,384621.4251,369.2329,ctr
pt203,583962.3522,384623.7331,369.0273,mtr
pt204,583962.1092,384622.7756,369.0380,mtr
pt205,583961.6221,384620.2727,369.0466,frtr
pt206,583960.6055,384620.0609,368.9755,frtr
pt207,583959.5624,384623.0651,368.8901,xtr
pt208,583958.2608,384623.1621,368.8250,frtr
pt209,583956.8615,384623.5787,369.0987,xtr
pt210,583957.1700,384624.6550,369.0864,xtr
pt211,583956.0435,384624.6899,369.0289,mtr
pt212,583958.2690,384632.4291,369.0034,mtr
pt213,583960.2429,384634.7269,368.9911,mtr
pt214,583961.2596,384635.3201,368.9579,mtr
pt215,583963.7406,384635.8015,368.9764,mtr
pt216,583963.5850,384633.7751,369.0440,mtr
pt217,583962.1476,384633.5406,369.0754,mtr
pt218,583961.1444,384633.0568,369.1376,mtr
pt219,583960.1149,384631.7757,369.1748,mtr
pt220,583957.5480,384626.2277,369.1109,mtr
pt221,583954.4791,384618.1449,369.1305,frtr
pt222,583955.3731,384617.7903,369.0729,frtr
pt223,583949.5611,384612.7660,369.1622,frtr
pt224,583949.0960,384611.7088,369.1744,frtr
pt225,583950.5410,384612.2466,369.1964,frtr
pt226,583947.9472,384598.4670,369.2313,captr
pt227,583947.0465,384598.5961,369.2301,captr
pt228,583978.8034,384633.4168,368.9618,mtr
pt229,583979.4780,384637.1944,369.0357,ctr
pt230,583981.2561,384637.1816,368.9765,ctr
pt231,583979.6565,384639.4583,369.1374,3xgplgzm
pt232,583980.2620,384649.5977,368.9789,gzm
pt233,583981.9481,384648.7643,368.9545,ctr
pt234,583983.6255,384648.6688,368.9695,ctrmd
pt235,583980.6484,384654.5080,369.0181,3gmetglmnglmn
pt236,583981.2769,384666.6449,369.0984,3xglmngplgzm
pt237,583983.6677,384666.6335,369.0264,md
pt238,583981.2994,384673.2022,369.1343,gzm
pt239,583983.4935,384673.2704,369.0493,mdmtr
pt240,583983.0785,384679.3793,369.0493,mdctr
pt241,583982.4614,384684.7384,369.0851,mdctr

E-mail: andra@topoland.ro
Mobil: 0741 784 393

Intocmit | Ing. Andra Gaborean
Aut. Seria | RO-CJ-F | Nr. 0291



pt242,583981.7381,384684.6170,369.2274,ctr
pt243,583982.3660,384679.3161,369.1986,ctr
pt244,583980.7871,384680.3561,369.2254,3xgzmgplgzm
pt245,583978.6267,384695.7165,369.2687,3xgzmgbetgmet
pt246,583980.7085,384695.8894,369.1076,mdmtr
pt247,583979.5243,384703.6732,369.1515,mdmtr
pt248,583977.7408,384701.6457,369.3056,gmet
pt249,583974.5289,384710.0287,369.4267,gmet
pt250,583973.4430,384712.9982,369.5079,gmet
pt251,583971.3717,384715.7965,369.6224,gmet
pt252,583968.8691,384718.7189,369.5845,gmet
pt253,583969.9602,384719.6400,369.3084,mdmtr
pt254,583973.0291,384716.4504,369.3654,mdmtr
pt255,583975.0149,384713.7192,369.3572,mdmtr
pt256,583977.8929,384708.3944,369.2461,mdmtr
pt257,583979.5227,384703.7118,369.1621,mdmtr
pt258,583974.5931,384723.9076,369.1842,mdmtr
pt259,583977.5977,384721.9209,369.2093,mdmtr
pt260,583981.2459,384720.5618,369.2286,mdmtr
pt261,583982.5349,384720.2645,369.1968,mdmtr
pt262,583997.4776,384718.3445,369.1656,mdmtr
pt263,584010.2476,384716.6062,369.1760,mdmtr
pt264,584023.0677,384714.8565,369.1472,mdmtr
pt265,584035.1102,384713.1595,369.1356,mdmtr
pt266,584047.7410,384711.3961,369.1720,mdmtr
pt267,584061.1464,384709.4700,369.1878,mdmtr
pt268,584077.4587,384706.9928,369.0441,mdmtr
pt269,584072.7404,384701.4297,369.1945,mdmtr
pt270,584071.2812,384700.0550,369.6355,gplxgmet
pt271,584071.9684,384699.9618,369.3815,frtr
pt272,584071.6580,384699.9519,369.2792,frgpl
pt273,584073.3379,384695.6187,369.1663,frgpl
pt274,584073.3186,384693.1624,369.1128,frgpl
pt275,584073.5189,384693.0360,369.2285,mtr
pt276,584073.8623,384694.8968,369.2106,mtr
pt277,584073.8486,384695.9030,369.2766,mtr
pt278,584073.4125,384697.8470,369.3168,mtr
pt279,584062.3811,384701.2967,369.7458,gmet
pt280,584062.5164,384702.8105,369.2076,mdmtr
pt281,584050.7707,384702.9910,369.6818,gmet
pt282,584051.1509,384704.3273,369.1610,mdmtr
pt283,584038.0821,384706.0749,369.2196,mdmtr
pt284,584037.5264,384704.7849,369.6479,gmet
pt285,584027.1049,384706.3304,369.2677,3xgmet
pt286,584023.5024,384706.9404,369.1759,gmetxgbet
pt287,584023.4986,384708.0594,369.1887,mdmtr
pt288,584011.4423,384709.6455,369.1786,mdmtr
pt289,584011.5649,384708.4340,369.4031,gbet

E-mail: andra@topoland.ro
Mobil: 0741 784 393

Intocmit | Ing. Andra Gaborean
Aut. Seria | RO-CJ-F | Nr. 0291



pt290,583997.2100,384710.1827,369.4361,gbet
pt291,583997.3795,384711.5506,369.2687,mdmtr
pt292,583987.7784,384712.9034,369.3050,mdmtr
pt293,583986.2473,384712.7873,369.3375,mdmtr
pt294,583985.0977,384711.6980,369.3063,mdmtr
pt295,583984.6595,384710.0748,369.2557,mdmtr
pt296,583984.7976,384708.5779,369.2038,mdmtr
pt297,583987.2716,384711.4241,369.4738,cgbetxgzm
pt298,583986.6368,384709.3277,369.2670,gzm
pt299,583987.9597,384702.4307,369.1897,gzm
pt300,583986.0657,384700.7613,369.1244,mdmtr
pt301,583989.2067,384695.0963,369.1927,3xgzm
pt302,583986.9708,384695.0875,369.1303,mdmtr
pt303,583988.6799,384683.6808,369.1019,mdmtr
pt304,583990.9345,384684.0501,369.2780,3xgzmgplgzm
pt305,583991.7970,384673.7886,369.2077,gzm
pt306,583989.5672,384673.7364,369.0526,mdmtr
pt307,583989.7168,384667.0897,369.0480,mdmtr
pt308,583992.4768,384667.1024,369.0192,3xgzmglmngzm
pt309,583992.2150,384655.6763,369.0632,3xgzmgbetgzm
pt310,583989.7021,384656.1548,369.0191,mdmtr
pt311,583989.6446,384646.5512,369.0003,mdmtr
pt312,583991.9907,384645.7335,369.1182,cgzmgmet
pt313,584008.2477,384638.6327,369.5362,cgarxglmn
pt314,584008.6358,384639.9642,369.8859,panxglmn
pt315,584011.0328,384638.0266,369.5279,cgar
pt316,584014.0858,384637.4953,369.6123,cgar
pt317,584015.2963,384638.7323,369.9503,garxanx
pt318,584062.9330,384633.6436,369.0368,ctrcplbet
pt319,584063.7893,384639.2993,369.0901,ctrcplbet
pt320,584064.4154,384639.1867,368.9679,ctr
pt321,584063.6284,384639.6773,369.1227,cgpl-ccl
pt322,584064.9093,384645.7084,369.3394,3xgpl
pt323,584065.5883,384646.0053,369.0114,mtr
pt324,584065.8803,384651.2927,368.8880,3gpl
pt325,584067.1821,384658.7238,369.0502,capgpl
pt326,584061.6783,384662.7548,369.0051,gpl
pt327,584060.5752,384662.7879,368.9155,3xgpl
pt328,584060.5899,384663.1780,368.9354,mtr
pt329,584060.9381,384664.8410,368.9492,mtr
pt330,584053.5881,384663.9876,369.0539,mtr
pt331,584051.5815,384664.3444,369.0097,mtr
pt332,584051.8492,384666.3744,368.9667,mtr
pt333,584051.3850,384664.6266,369.0092,xtr
pt334,584053.9344,384664.1414,368.9653,xtr
pt335,584053.8297,384663.9538,368.9590,cgpl
pt336,584043.1657,384665.7492,369.0099,ctr
pt337,584042.6207,384667.9251,369.1747,ctr

E-mail: andra@topoland.ro
Mobil: 0741 784 393

Intocmit | Ing. Andra Gaborean
Aut. Seria | RO-CJ-F | Nr. 0291



pt338,584042.0842,384660.0251,369.1079,gmetmtr
pt339,584041.0509,384660.2340,369.0744,gmetmtr
pt340,584034.4954,384660.7161,369.4115,3xgpl
pt341,584035.8768,384661.2136,370.3265,canxgpl
pt342,584032.8069,384655.3166,369.2532,gpl
pt343,584042.5990,384677.8215,368.9415,gpl
pt344,584045.1613,384677.5118,369.3437,gpl
pt345,584050.1739,384677.1100,369.3717,gpl
pt346,584062.4023,384675.9458,368.9007,gpl
pt347,584070.1264,384675.0657,369.0912,cgpl
pt348,584070.5820,384674.4951,369.1876,ctr
pt349,584071.6121,384683.4140,369.0046,3xgpl
pt350,584071.9740,384683.3169,369.1610,mtr
pt351,584069.4295,384668.1166,368.9596,ctr
pt352,584068.6693,384663.9112,368.9291,xtr
pt353,584068.3342,384661.9250,368.9354,xtr
pt354,583980.4152,384583.8609,369.3963,st1
pt355,583980.4162,384583.8602,369.3863,st1
pt356,583980.4141,384583.8657,369.3947,st1
pt357,584037.7637,384624.7651,369.0064,st2
pt358,584037.7650,384624.7651,369.0187,st2
pt359,584037.7697,384624.7600,369.0159,st2
pt360,584041.9985,384675.9342,369.8585,cgarxanx
pt361,584042.1091,384677.6162,369.3626,canx
pt362,584038.7486,384660.7269,368.9337,cgar280cm
pt363,584032.8001,384655.3053,369.2873,gpl
pt364,584035.0250,384657.0747,368.8426,alagaraj
pt365,584034.5168,384660.6891,369.3372,3xgpl
pt366,584051.8704,384670.8227,368.8910,cgar
pt367,584052.4731,384676.2671,369.2843,cgar
pt368,584058.8910,384670.0066,368.8646,cgar
pt369,584059.5098,384675.7389,369.3419,cgar
pt370,584055.4847,384670.4464,369.8283,xgar

Data intocmire: 13.03.2024

E-mail: andra@topoland.ro
Mobil: 0741 784 393

Intocmit | Ing. Andra Gaborean
Aut. Seria | RO-CJ-F | Nr. 0291

